

# LOCATOR FIXED

*A simple and affordable fixed solution, by the creators of LOCATOR*

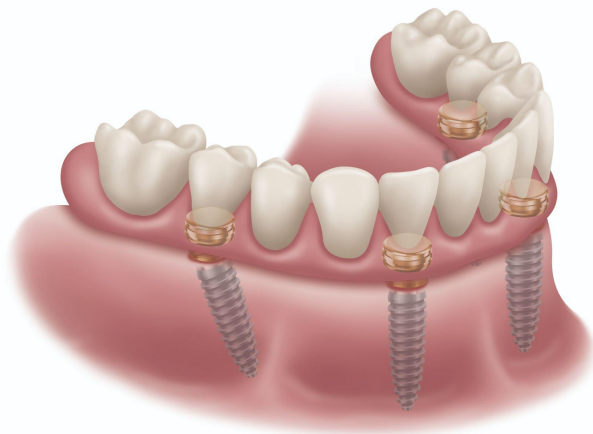

# Options for Edentulous Patients: Today

## DENTURE

## Permanent TEETH

### Denture



### 2 Implant Overdenture

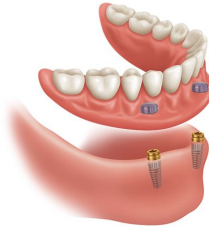

### 4 Implant Overdenture

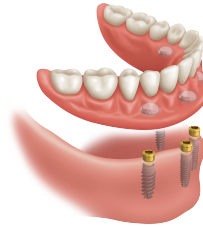

No  
Affordable  
Option

### Screw Retained (Fixed)



### Poor

### Good

### Better

### Best

- Uses denture adhesive to secure
- Low quality of life and uncomfortable

- Implant Retained
- Secure but some movement
- Removeable

- Implant Retained
- More secure but some movement
- Removeable

- Fixed for patient
- Price point not attainable for everyone

Patient  
Experience

Treatment  
Details

# Options for Edentulous Patients: Future

## DENTURE

## Permanent TEETH

### Denture



### 2 Implant Overdenture

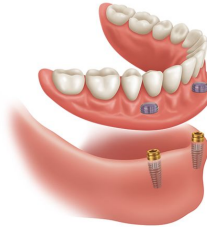

### 4 Implant Overdenture

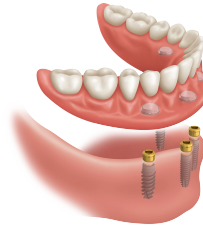

### LOCATOR Fixed

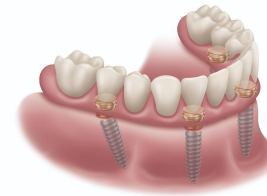

### Screw Retained (Fixed)



Patient  
Experience

**Poor**

**Good**

**Better\***

**Alternative**

**Best**

Treatment  
Details

- Uses denture adhesive to secure
- Low quality of life and uncomfortable

- Implant Retained
- Secure but some movement
- Removeable

- Implant Retained
- More secure but some movement
- Removeable

- Fixed for Patient
- Quick maintenance appts and attainable price point
- Fixed but easily change to removable.

- Fixed for patient
- Price point not attainable for everyone

# LOCATOR FIXED™ vs. LOCATOR® Removable

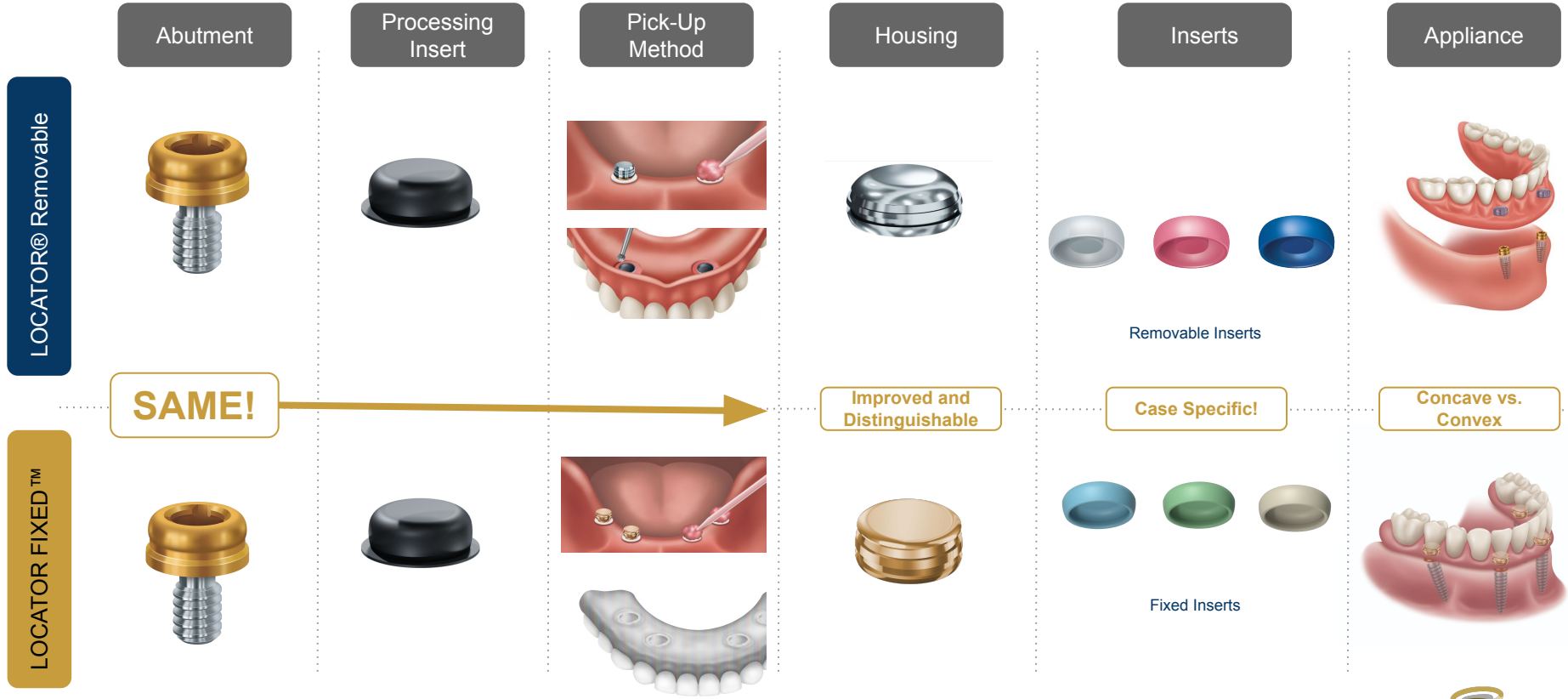

# LOCATOR **FIXED**™ from Zest....

## reMOVEable **FIXED**

- Uses the same abutment and the same workflow, but in a **FIXED** solution following the same protocol for pickup method greatly reducing the investment needed to offer fixed full arch solutions.
- When combined with any LOCATOR® abutment, LOCATOR proprietary **FIXED** inserts can make it possible for the patient to choose between removable and **FIXED**, with less or no bone reduction\*
- Compatibility with nearly every implant solution is now...**FIXED**.
- The unrivaled **FIXED** offering for your patients, from the most trusted solution for edentulous patients; lower costs, shorter appointments, and less invasive procedures.

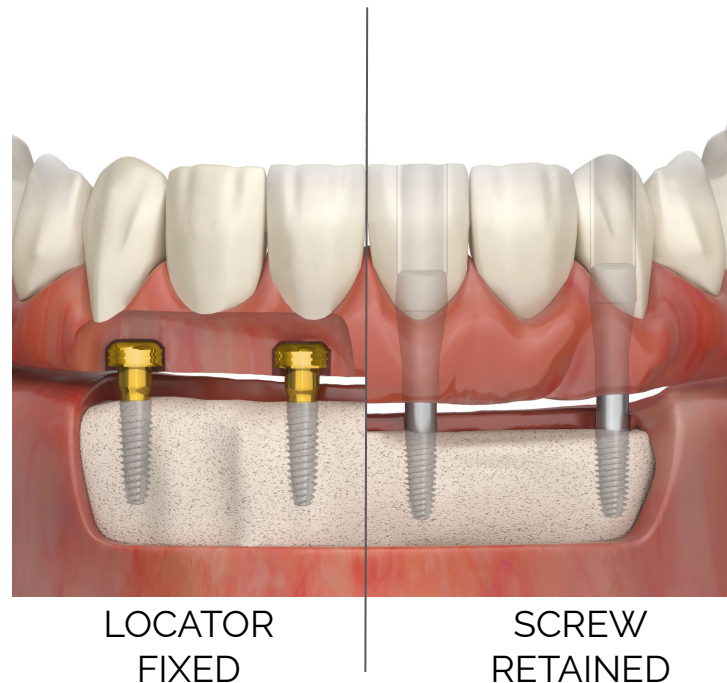

\*Individual patient situations may vary.

# LOCATOR **FIXED**™ Product Features



## **LOCATOR FIXED Housing**

is engineered to have higher retention/bond strength while maintaining the same pick-up method as existing **LOCATOR** housings.

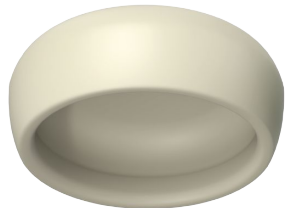

## **Proprietary LOCATOR FIXED Inserts**

Ultra precision manufactured **FIXED** inserts made of rigid material designed to match the inner geometry of our LOCATOR FIXED housing to create the interaction needed in the system to perform as a fixed full arch solution. Corrects up to 20 degrees of total implant divergence.



## **LOCATOR Abutments**

Build on what you already know and trust in your practice -- **LOCATOR®. Zest LOCATOR FIXED** delivers a fixed full arch solution using existing LOCATOR abutments.

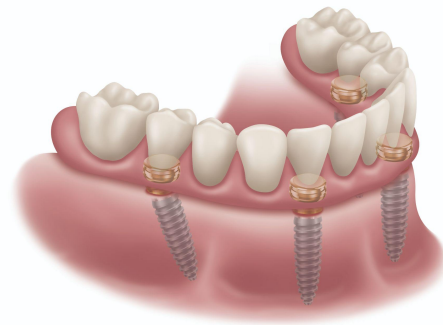

# Product Details for **LOCATOR FIXED™**



LOCATOR FIXED Housing

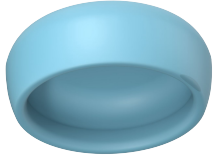

LOCATOR FIXED Mid Arch Insert

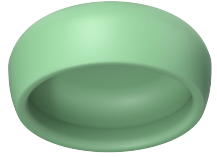

LOCATOR FIXED Four Unit Insert

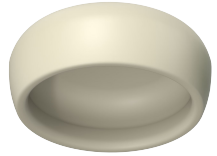

LOCATOR FIXED Anterior/Posterior Insert

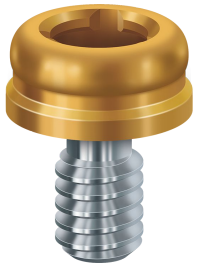

LOCATOR Abutment

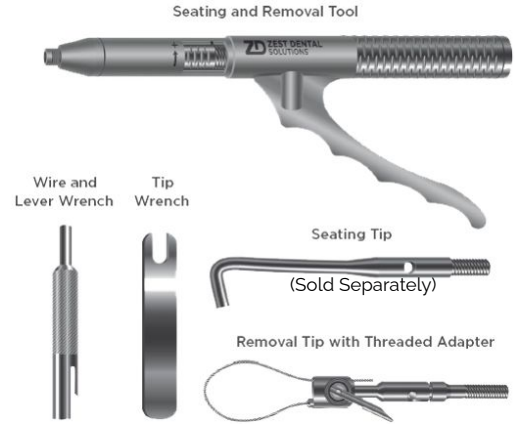

LOCATOR FIXED Seating and Removal Tool



LOCATOR System Enhanced Core Tool

# Insert Placement by Implant Position for **LOCATOR FIXED™**



LOCATOR FIXED  
Housing

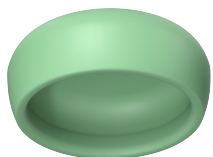

LOCATOR FIXED  
Four Unit Insert

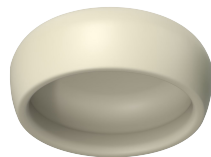

LOCATOR FIXED  
Anterior/Posterior Insert

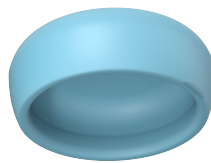

LOCATOR FIXED  
Mid Arch Insert

## 4 IMPLANTS

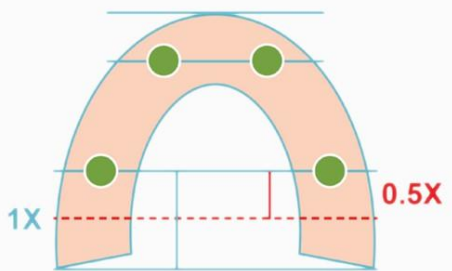

## 5 IMPLANTS

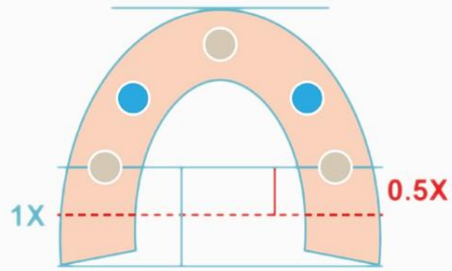

## 6 IMPLANTS

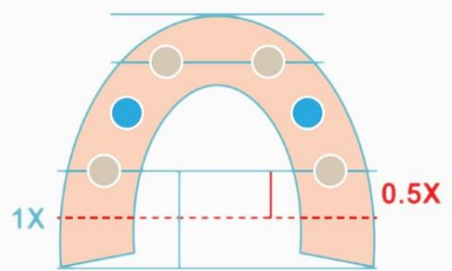

For more than 6 implants: Use Tan Inserts in the most anterior/posterior positions in each quadrant

NOTE: Do NOT reuse inserts. Inserts must be replaced after each removal.

# Prosthetic Space Required for **LOCATOR FIXED™**

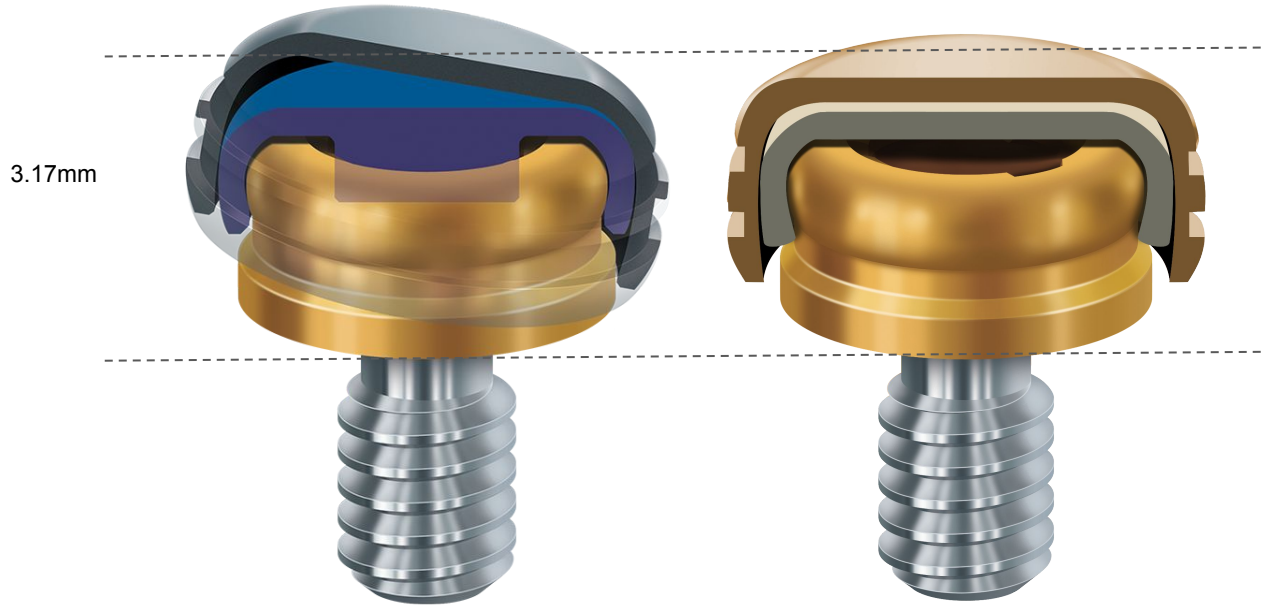

Same exact stack up height  
as LOCATOR removable  
allows for...

**LOCATOR FIXED treatment**  
in **9-11mm** of prosthetic  
space. (Normally requires  
12-15mm)

# Prosthesis Recommendations for for **LOCATOR FIXED™**

## CASE REQUIREMENTS

- Minimum of four (4) implants with cross-arch stabilization.
- Minimum of 35Ncm or full osseointegration of all implants prior to loading.
- Angle correction up to 20° per implant in any direction.
- Prosthesis cantilevers should be no more than **1X A/P Spread**.
- Bruxers/Clenchers: No more than **0.5X A/P Spread**.

## PRE-SURGICAL AND PROSTHETIC PLANNING

### PROSTHETIC CLEARANCE

- The proper selection of the cuff size is imperative when pre-planning a case.
- The prosthesis should sit above the tissue.
- The choice of restorative material may require more vertical clearance.

### CANTILEVERS

- Shorter cantilevers are recommended.
- NON-BRUXERS: Maximum cantilever should be no more than one molar past the most distal implant or 1X A/P Spread.
- BRUXERS/CLENCHERS: Maximum cantilever should be no more than one half molar past the most distal implant or 0.5X A/P Spread.
- Ensure the prosthesis extends at least 2mm past the most posterior Abutments to allow the Removal Loop to engage for prosthesis removal.

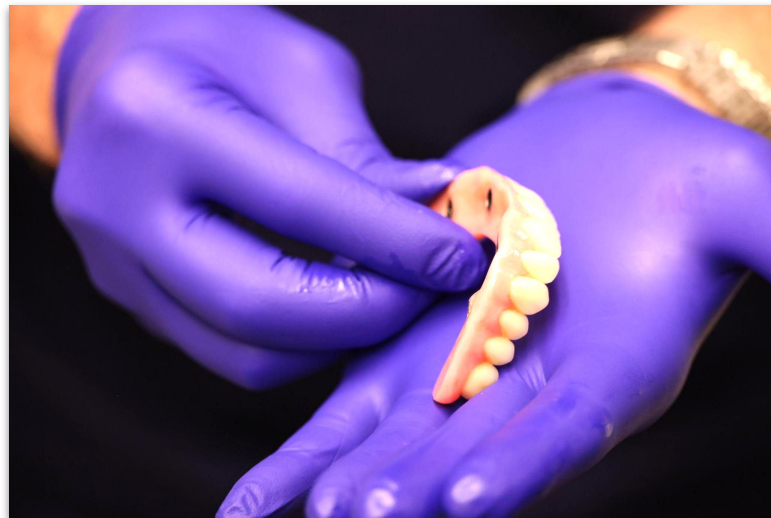

# Prosthetic Guidelines for **LOCATOR FIXED™**

## **Good Options...**

Metal to porcelain frameworks, Zirconia frames, Crystal Ultra base frameworks, Long-term prosthesis should be reinforced, use of APM/CemEZ for housing retention, use blockout spacers, solid bite registration

## **Not So Good Options...**

Printed, milled, packed, or pour technique dentures without reinforcement (especially with pre-existing repaired fractures), excessive cantilevers, patients with below recommended interocclusal space, wide flat or concave intaglio surfaces that make it hard for patients to clean,



# Product Family Compatibilities for **LOCATOR FIXED™**

Compatible with LOCATOR FIXED

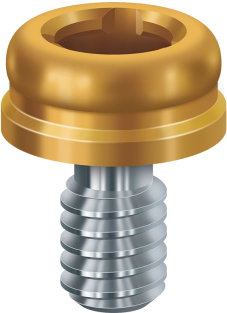

LOCATOR Abutments



LOCATOR Implants



LOCATOR Multi-Unit  
Abutment

# Enhanced Core Tool for **LOCATOR®** and **LOCATOR FIXED™**

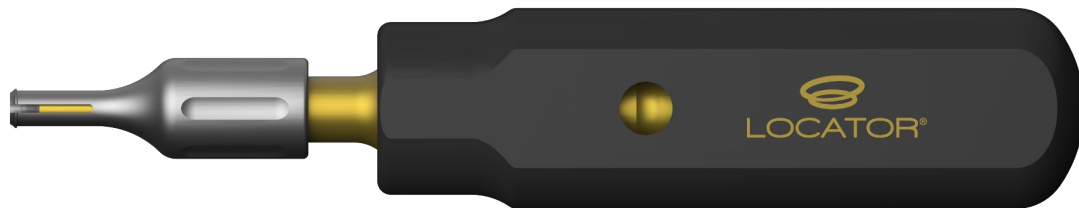

- One streamlined tool compatible with LOCATOR Removable and LOCATOR FIXED Inserts
- Two-sided Insert designed for easy insertion and removal of any LOCATOR Insert
  - **Insertion Tip:** Effortlessly pickup inserts for transfer and placement in housing
  - **Removal Tip:** Place tip with closed prongs into insert, twist collet to open prongs, tilt core tool and easily remove any LOCATOR Insert

Removal Collet



Removal End



Insertion End

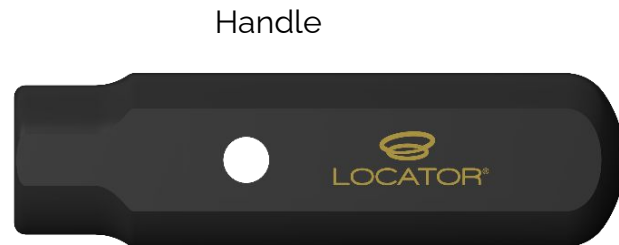



## SEATING THE PROSTHESIS

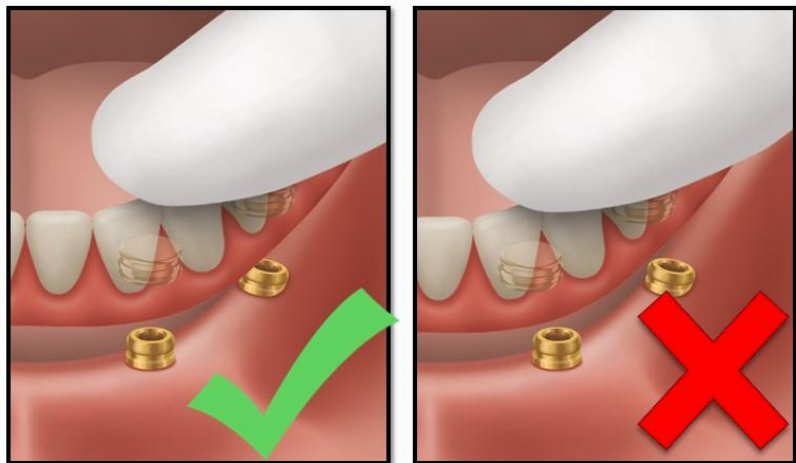

Failure to ensure that the Retention Inserts are aligned with the LOCATOR FIXED Abutments can result in damage to the inserts, housing or prosthesis.

Press firmly around the arch to seat the prosthesis. An audible click may be heard and confirms the seat.